

COPIES OF THIS MAP ARE AVAILABLE TO THE PUBLIC AT A NOMINAL COST. ADDRESS: N.C. DEPARTMENT OF TRANSPORTATION INFORMATION, MAPPING, AND GRAPHICS 200 CAROL BANKERS BLDG. CT. RALEIGH, N.C. 27610

| | | |
|----------|----------|-----------------|
| REVISION | DATE | DESCRIPTION |
| 1 | 11/10/00 | INITIAL RELEASE |
| 2 | 03/11/01 | ADDED NEW DATA |
| 3 | 03/11/01 | ADDED NEW DATA |
| 4 | 03/11/01 | ADDED NEW DATA |
| 5 | 03/11/01 | ADDED NEW DATA |
| 6 | 03/11/01 | ADDED NEW DATA |
| 7 | 03/11/01 | ADDED NEW DATA |
| 8 | 03/11/01 | ADDED NEW DATA |
| 9 | 03/11/01 | ADDED NEW DATA |
| 10 | 03/11/01 | ADDED NEW DATA |

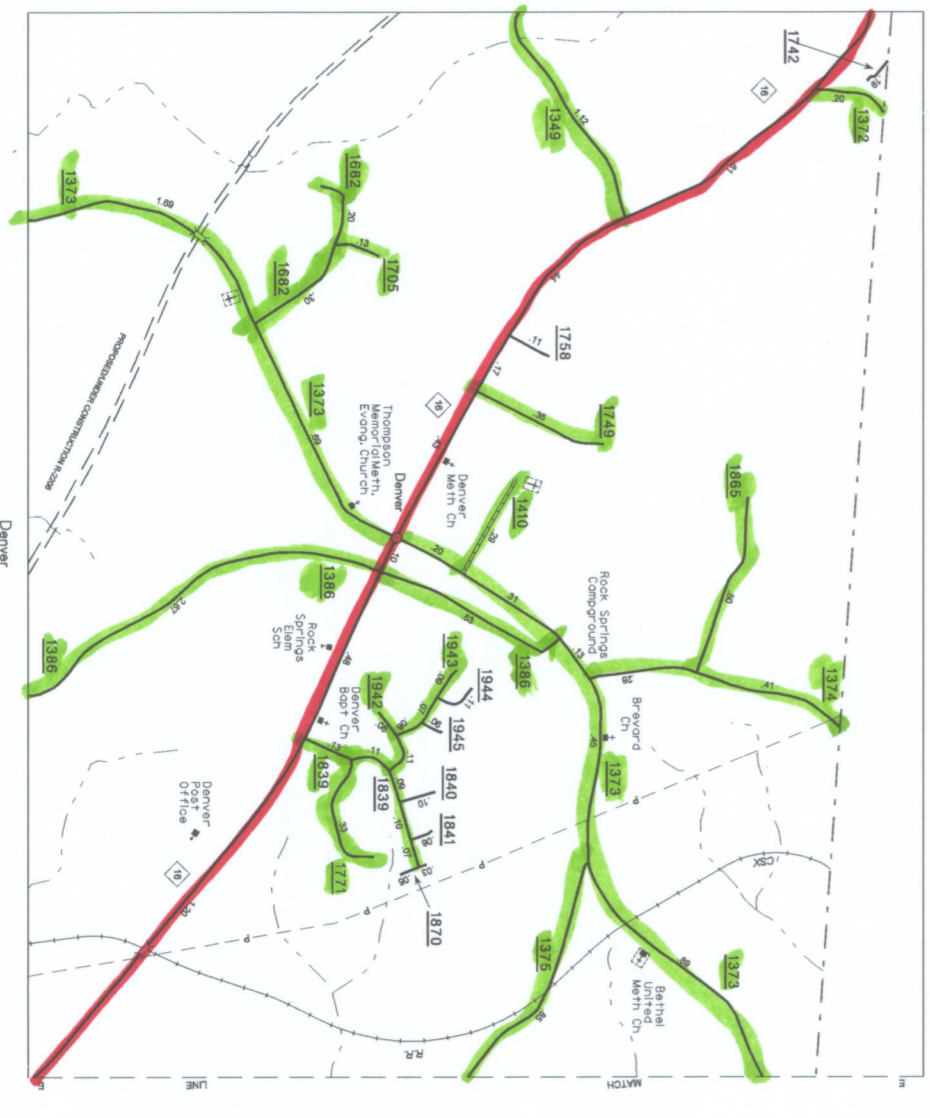

Key:
 Blue - Divided highway to be mowed
 Red - Primary Routes to be mowed
 Green - Secondary Routes to be mowed

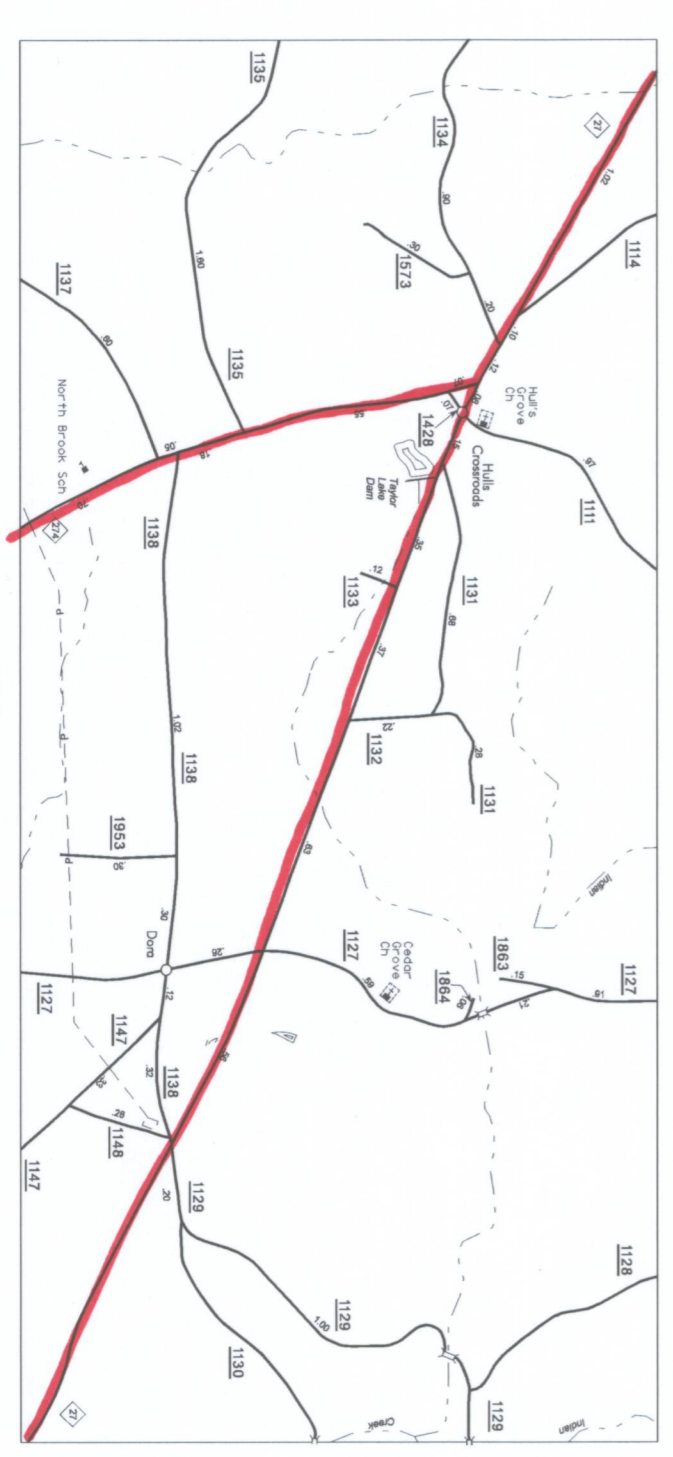
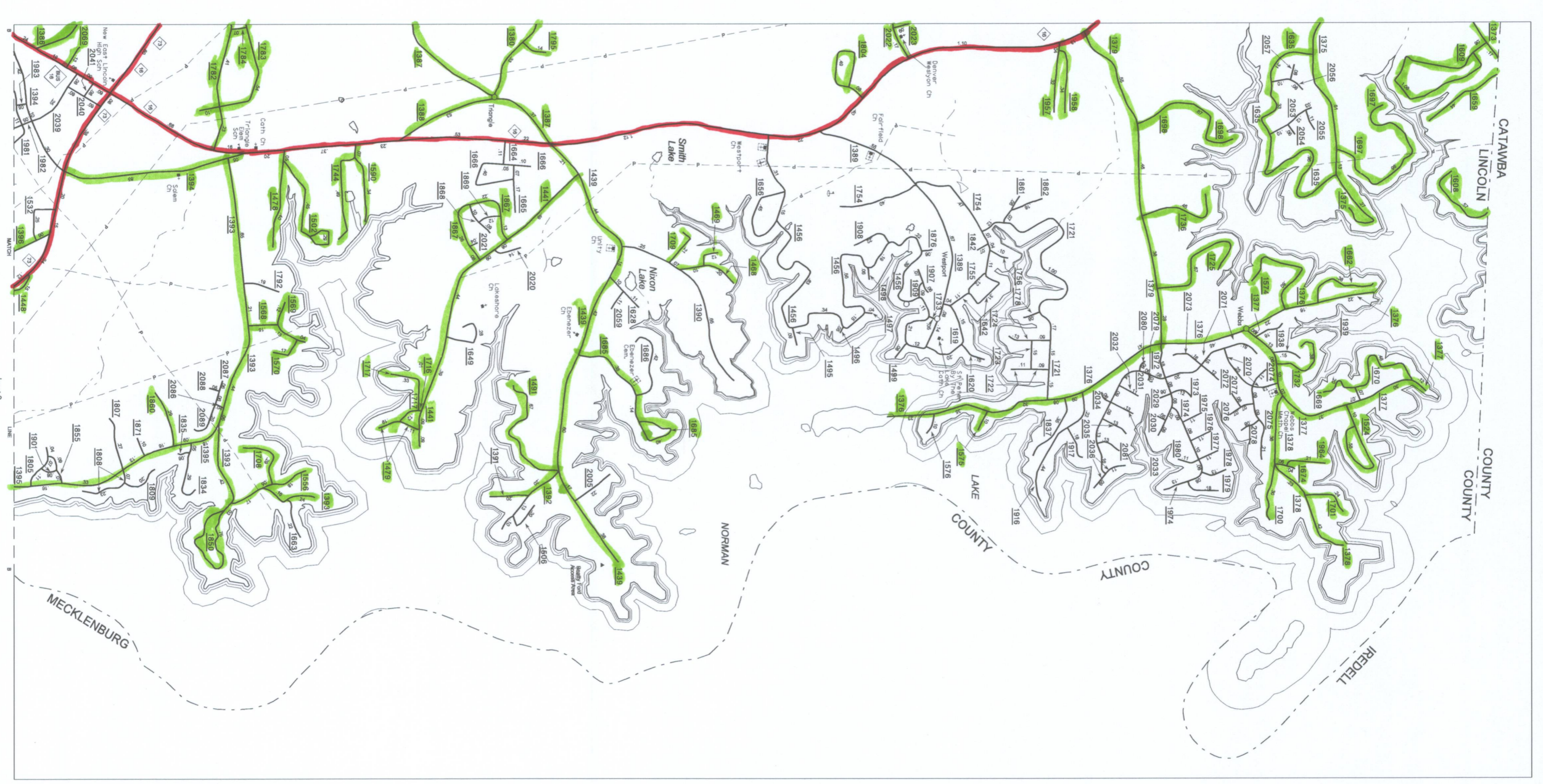
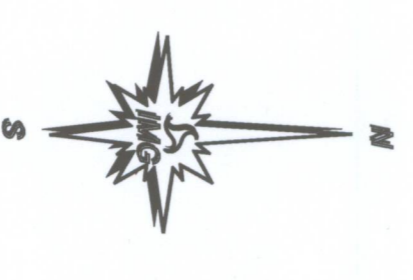
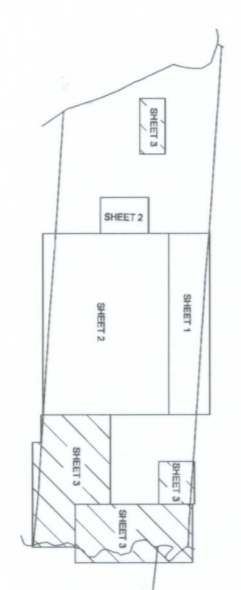

ENLARGED MUNICIPAL AND SUBURBAN AREAS
LINCOLN COUNTY
 NORTH CAROLINA
 PREPARED BY THE
 NORTH CAROLINA DEPARTMENT OF TRANSPORTATION
 STATE ROAD MAINTENANCE UNIT - MAPPING AND INFORMATION SECTION
 U.S. DEPARTMENT OF TRANSPORTATION
 FEDERAL HIGHWAY ADMINISTRATION

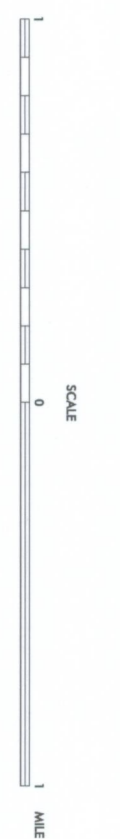

COPIES OF THIS MAP ARE AVAILABLE TO THE PUBLIC AT A NOMINAL COST. ADDRESS: N. C. DEPARTMENT OF TRANSPORTATION, INFORMATION, MAPPING AND GRAPHICS, 5400 CARL SANDERS BLVD. CT., RALEIGH, N.C. 27610

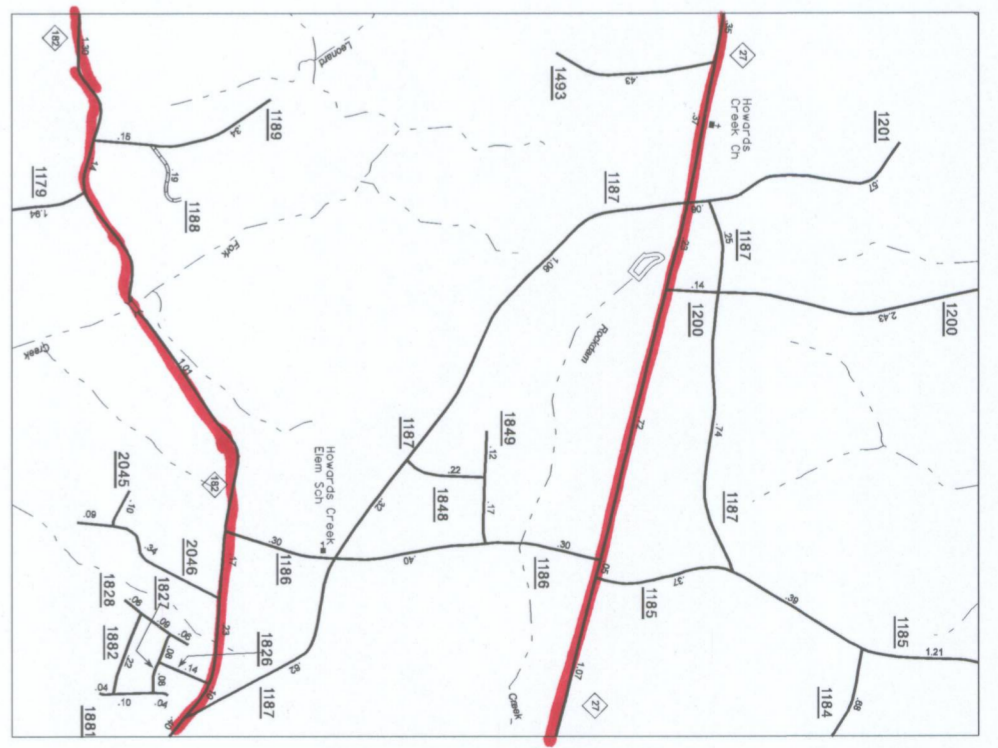
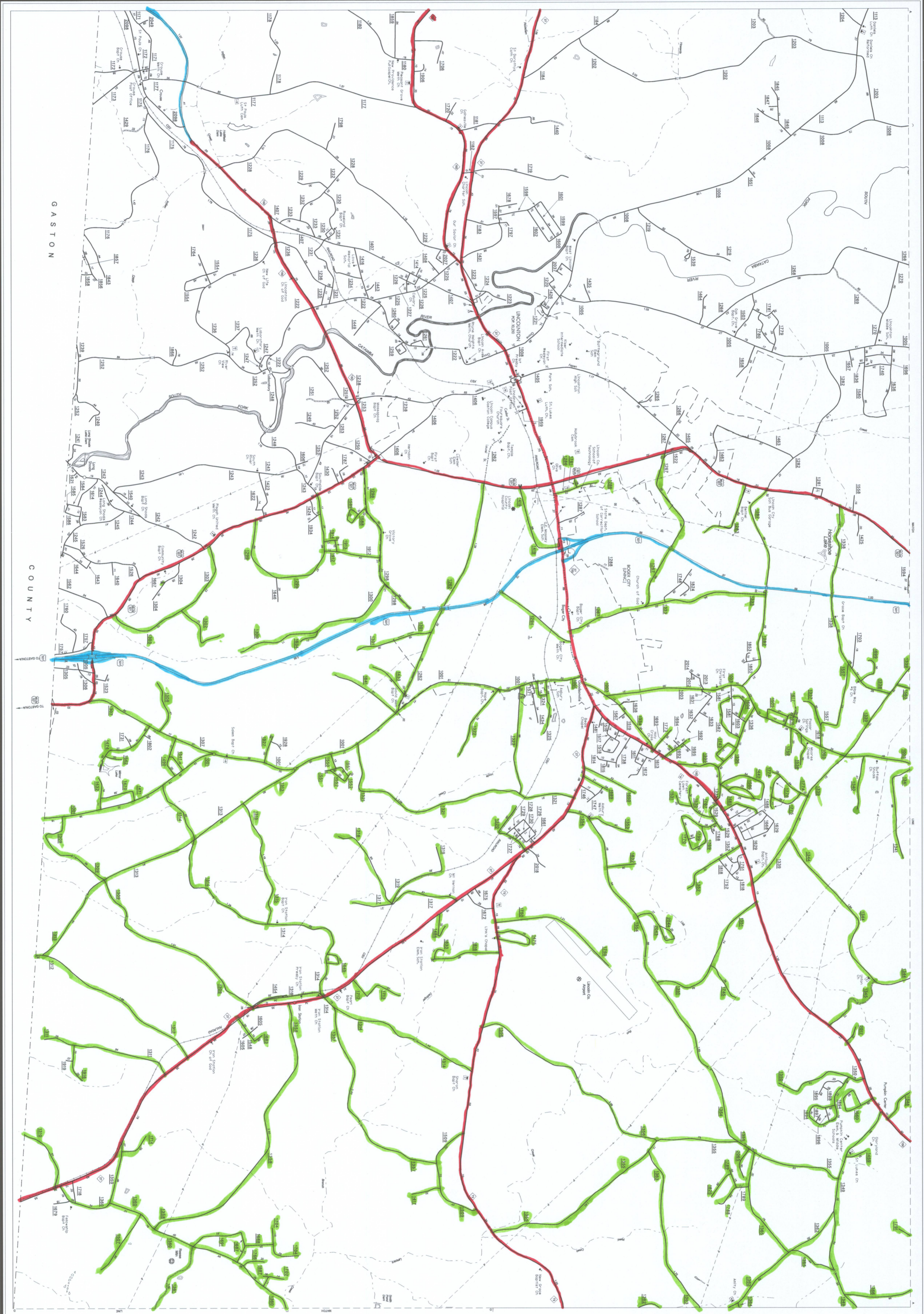

Key:
 Blue - Divided highway to be mowed
 Red - Primary Routes to be mowed
 Green - Secondary Routes to be mowed

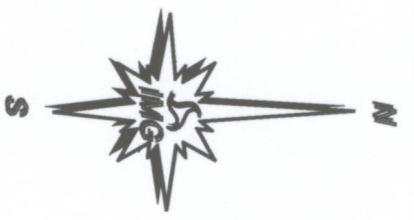
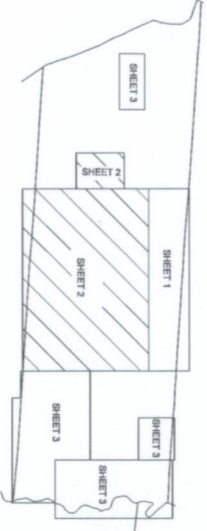

ENLARGED MUNICIPAL AND SUBURBAN AREAS
LINCOLN COUNTY
 NORTH CAROLINA
 PREPARED BY THE
 NORTH CAROLINA DEPARTMENT OF TRANSPORTATION
 STATE ROAD MAINTENANCE UNIT - MAPPING AND INFORMATION SECTION
 IN COOPERATION WITH THE
 U.S. DEPARTMENT OF TRANSPORTATION
 FEDERAL HIGHWAY ADMINISTRATION
 SCALE 1:50,000

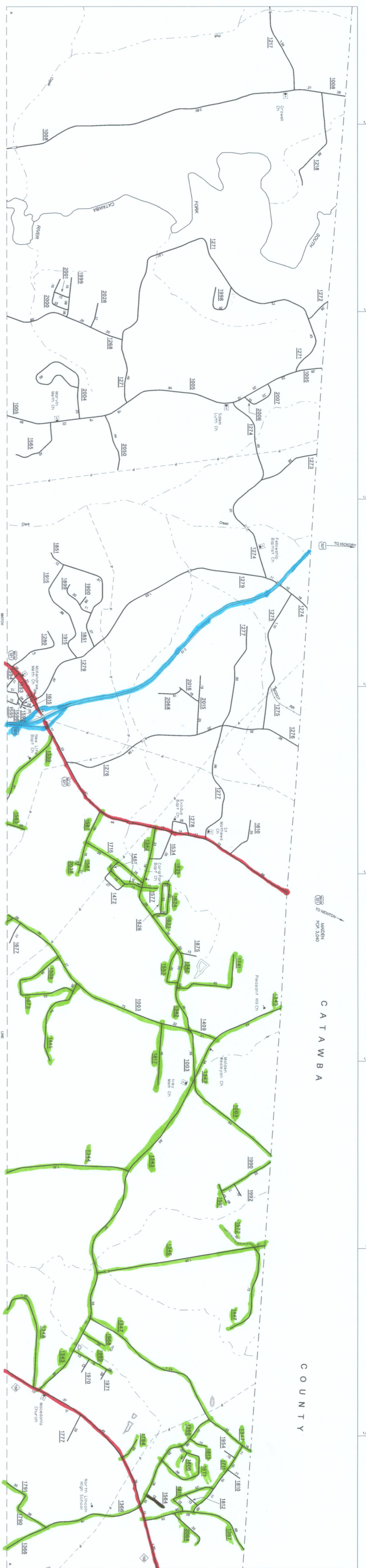

Key:
 Blue - Divided highway to be moved
 Red - Primary Routes to be moved
 Green - Secondary Routes to be moved

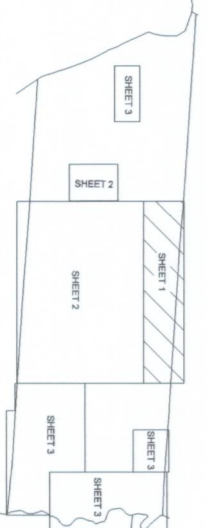

ALSO NUMBERS 1001 1002 1003 1004 1005 1006

NOTE: MAP INCLUDES ONLY STATE MAINTAINED ROADS OR IMPORTANT NON-STATE ROADS SHOWN AS OF FEB. 3, 2010

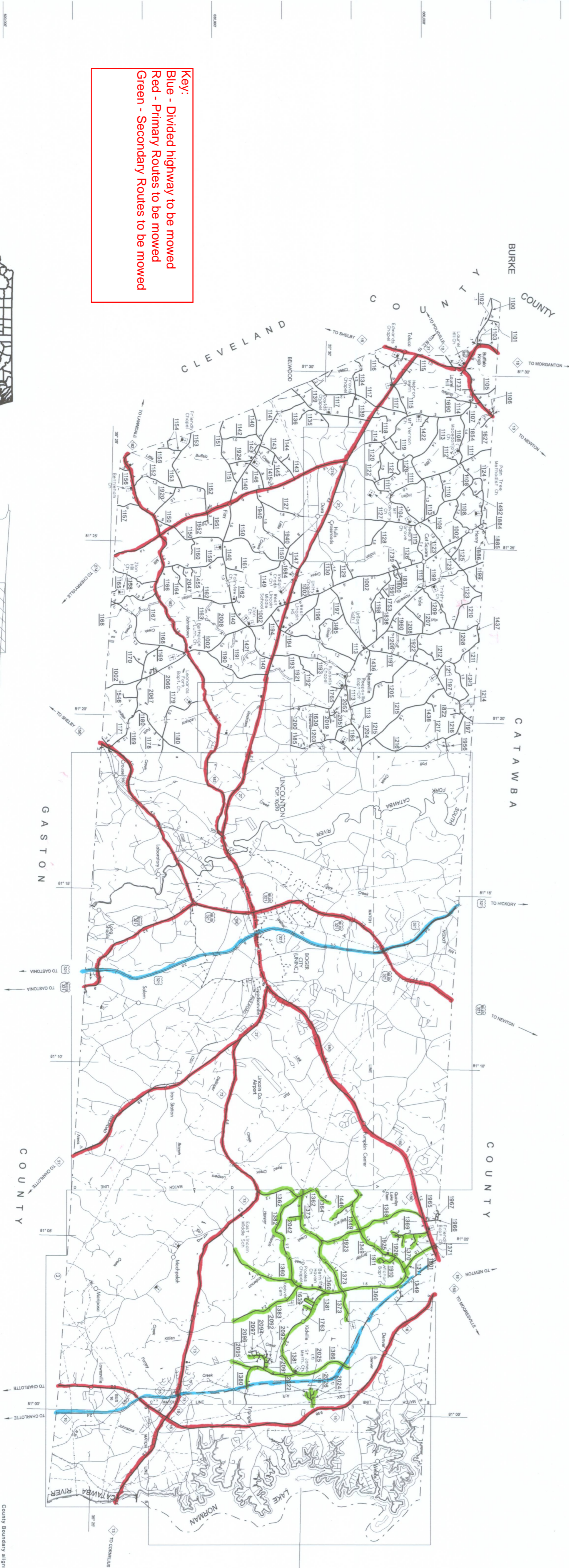

LINCOLN COUNTY
 NORTH CAROLINA
 FEDERAL HIGHWAY ADMINISTRATION

PREPARED BY THE
 NORTH CAROLINA DEPARTMENT OF TRANSPORTATION
 STATE ROAD MAINTENANCE UNIT - MAPPING AND INFORMATION SECTION
 U.S. DEPARTMENT OF TRANSPORTATION
 FEDERAL HIGHWAY ADMINISTRATION

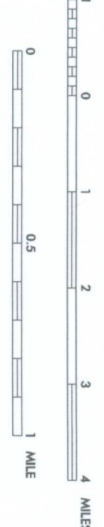

SCALE FOR BAR BAR

LEGEND

- PAVED OR UNPAVED ROAD
- SOIL GRAVEL OR STONE SURFACED ROAD
- HAZARD SURFACED ROAD
- DIVIDED HIGHWAY
- HIGHWAY WITH FRONTAGE ROADS
- RAIL CONTROL ACCESS
- RAILROAD LOCATION
- INTERSECTION DISTANCE
- THRUIC CIRCLE
- HIGHWAY INTERCHANGE
- DETAILED HIGHWAY INTERCHANGE
- ROAD THROUGH MOUNTAIN PASS
- HIGHWAY BRIDGE
- UNDERPASS
- DRIVE SHAUL ON BRIDGE
- FERRYWAY TUNNEL
- INTERSTATE HIGHWAY
- U.S. NUMBERED HIGHWAY
- U.S. NUMBERED BRIDGE ROUTE
- N.C. NUMBERED BRIDGE ROUTE
- INDEPENDENT BRIDGE NUMBER
- SECONDARY ROAD NUMBER
- RAILROAD STATION
- RAILROAD CROSSING
- UNDERPASS
- CORNERSTONE
- INLET AREA
- REGULAR ESTIMATION
- REGISTRATION OR CITY LIMIT
- NATIONAL FOREST BOUNDARY
- FEDERAL GAME AND BOUNDARY
- STATE GAMELAND BOUNDARY
- COUNTY LINE
- STATE LINE
- CITY OR VILLAGE (UNINCORPORATED)
- FERRY OR TOLL FERRY
- CANAL
- NARROW STREAM
- WIDE STREAM
- DAIRY
- DAIRY LOCK
- RESERVATION ZONE OR LAKE
- COUNTY SEAM AND ZONE CENTER
- CORNER
- CHURCH
- HOSPITAL
- CHURCH WITH CHIMNEY
- CHEMISTRY
- CONNECTION OR FURNACE
- HIGHWAY DIV OR DIST OFFICE
- WATER STATION
- HISTORICAL SITE
- LIGHTHOUSE
- REST AREA
- REGULATORY STATION
- MILITARY AIRFIELD
- HARBOR ON FIELD
- LANDING STRIP
- LANDING STRIP